

FOR LEASE

30942 Industrial Road,
Livonia



Office/Light Industrial

Local Ownership and Management

Features

- 4,000 SF
- 500 Office SF, Will Build to Suit
- 12' X 12' Overhead Door
- 10' X 10' Truckwell
- 16' – 18' Clearance
- Newly Landscaped
- Ample Parking
- May be combined with unit 30942A for a total of 7,170 sf

Location

- Just South of I-96 Between Merriman and Middlebelt
- Conveniently Located to I-96, I-275 and Telegraph

Leasing

- Fast Occupancy
- Flexible Lease Terms
- Competitive Rates - \$6.50 gross / \$2,167/mo.

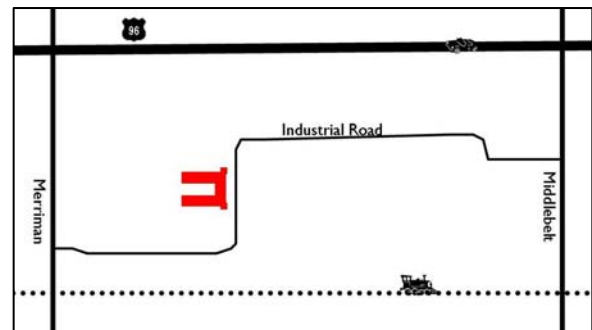

Please contact:

Tyson Butts
Corporate Leasing Manager
248.331.0215
tbutts@gvadetroit.com



PO Box 4013
Southfield, MI 48037

www.zicorproperty.com

Information contained herein is believed to be accurate but is not warranted as to accuracy and may change or be updated without notice. Seller or landlord makes no representation as to the environmental condition of the property and recommends Purchaser's or Tenant's personal investigation.

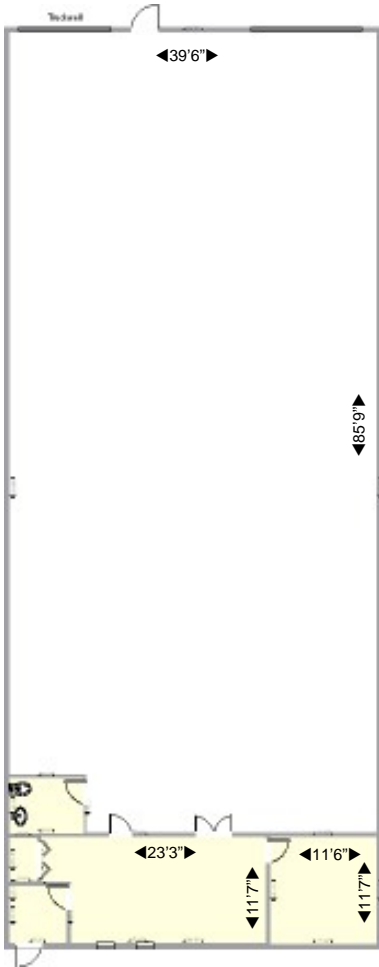
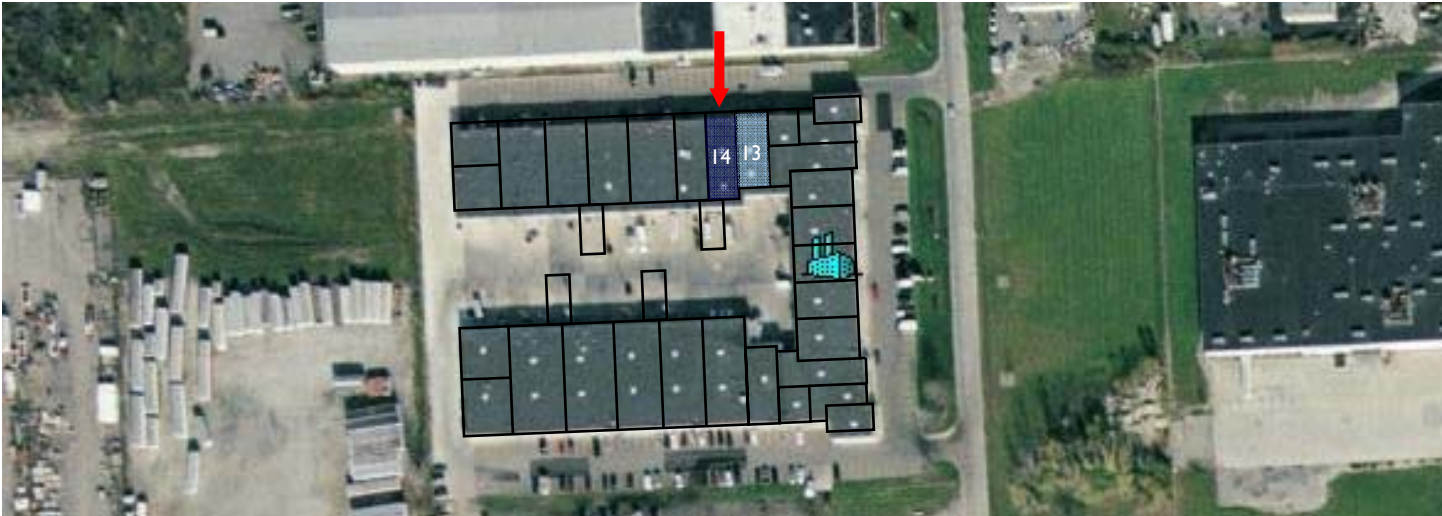

Unit 14

Dimensions are approximate and should be verified by Tenant.

Tyson Butts
248.331.0215
tbutts@gvadetroit.com

PO Box 4013
Southfield, MI 48037
www.zicorproperty.com