

# FOR LEASE

32522 Dequindre,  
Warren



Office/Light Industrial

Local Ownership and Management

## Features

- 3,100 SF
- 375 SF Office
- 1 OHD
- 16' – 18' Clearance
- 240 Volt 3-Phase Power
- Newly Landscaped Entryway
- Can Build Office to Suit
- Ample Parking

## Location

- East Side of Dequindre Just South of I4 Mile
- Conveniently Located to I-696 & I-75

## Leasing

- Fast Occupancy
- Flexible Lease Terms
- Competitive Rates - \$6.50 gross / \$1,679/mo.



## Please contact:

Tyson Butts  
Corporate Leasing Manager  
248.331.0215  
tbutts@gvadetroit.com



3000 Town Center  
Suite 2222  
Southfield, MI 48075  
248.262.8000  
248.262.8013 f  
www.zicorproperty.com

Information contained herein is believed to be accurate but is not warranted as to accuracy and may change or be updated without notice. Seller or landlord makes no representation as to the environmental condition of the property and recommends Purchaser's or Tenant's personal investigation.



Can be combined with unit 32526 for a total of 5,600 sf at a rate of \$6.50 gross

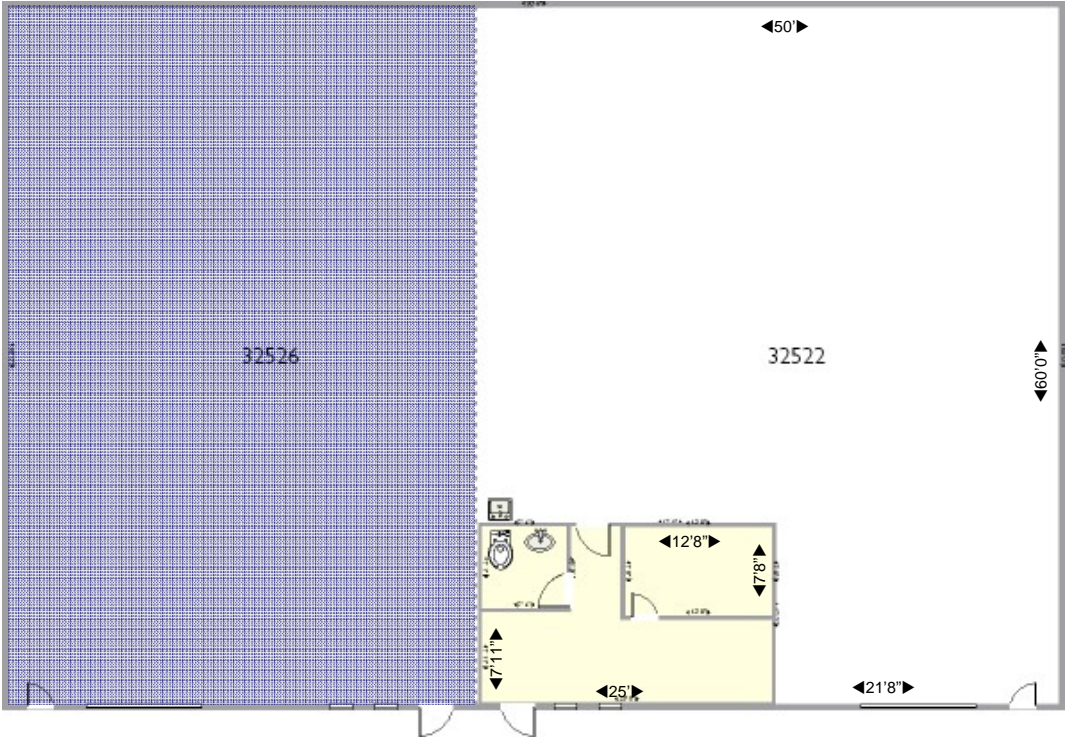

Dimensions are approximate and should be verified by Tenant.

Tyson Butts  
 248.331.0215  
 tbutts@gvadetroit.com

3000 Town Center, Suite 2222  
 Southfield, MI 48075  
 www.zicorproperty.com